

Attachment B

Office Redesign Final Phase

RFP ADDITIONAL RESOURCE

2024-2025 FY

All images and designs were obtained during market research and are samples of what is being procured. Vendors should use this as a guide to identify their products that meet the same needs and do not have to have the exact product used in this document.

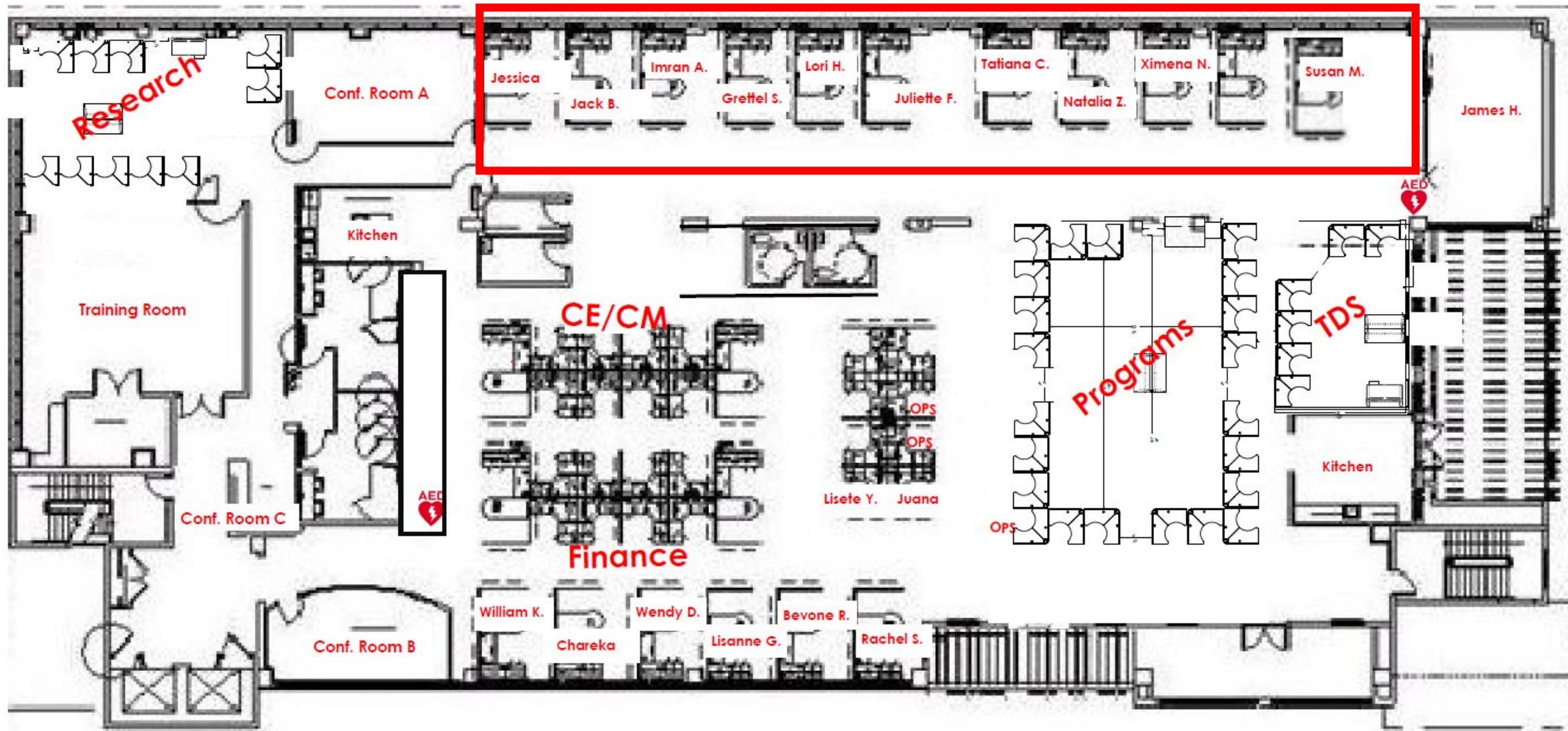



SAMPLE FURNITURE STYLE



Executives and Directors Area

Additional Information:

- Want 15 desk, min. 14
- Nothing blocking windows to exterior
- Frosted door/wall facing interior.
- Frosted between offices.
- Provide storage solution
- Allow for seating of 2 guest.
- Electrical provided off wall under windows. Office will need to obtain electricity from this area.

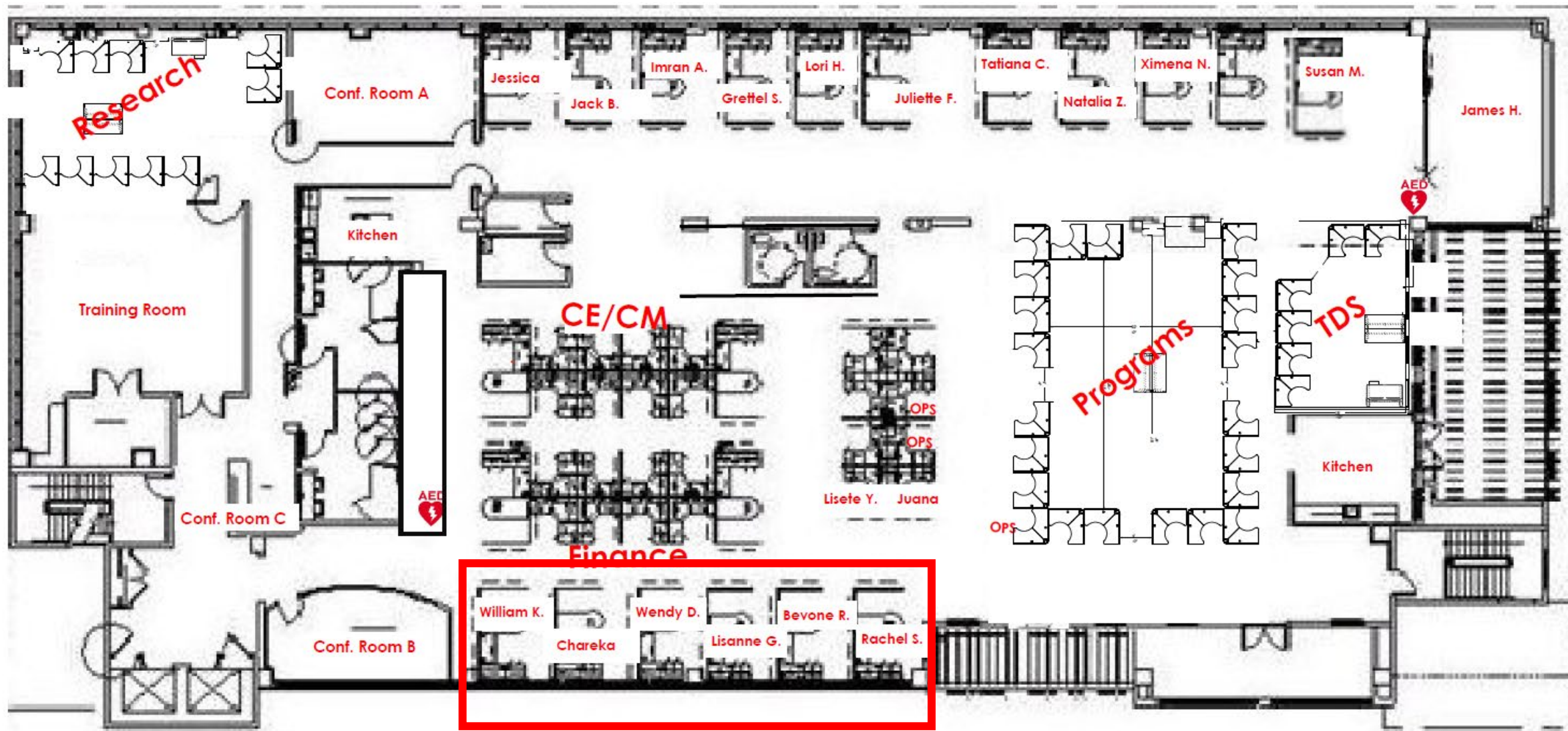

Hallway into the office towards Programs and large Kitchen

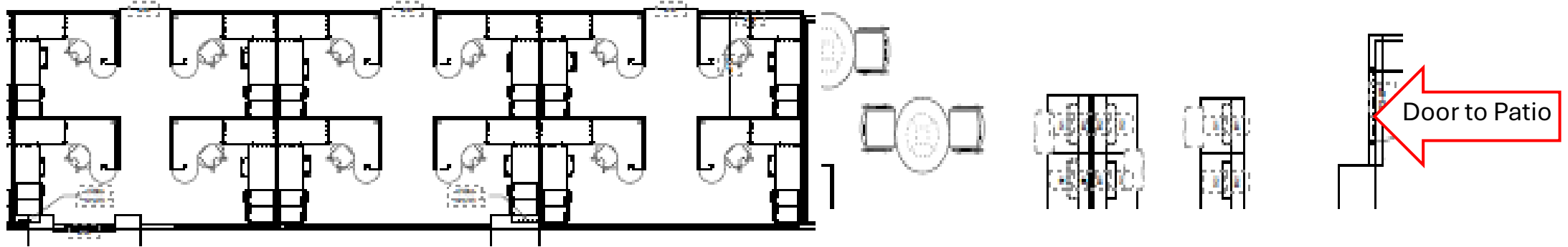

SAMPLE FURNITURE STYLE

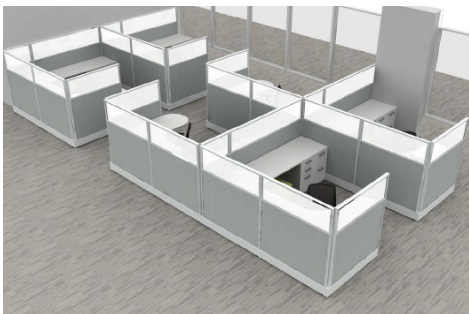

Remove the section with round end or relocate to allow for chair inside nook area

Associate Directors/Higher Privacy Need Area

Additional Information:

- Want 12, min. 9
- Nothing blocking windows outside.
- Height of existing furniture.
- Include frosted element to allow light to flow to interior
- Provide storage solution.
- Allow for seating of 1 guest.
- Electricity along wall under windows must feed all desk in this area.

SAMPLE FURNITURE STYLE



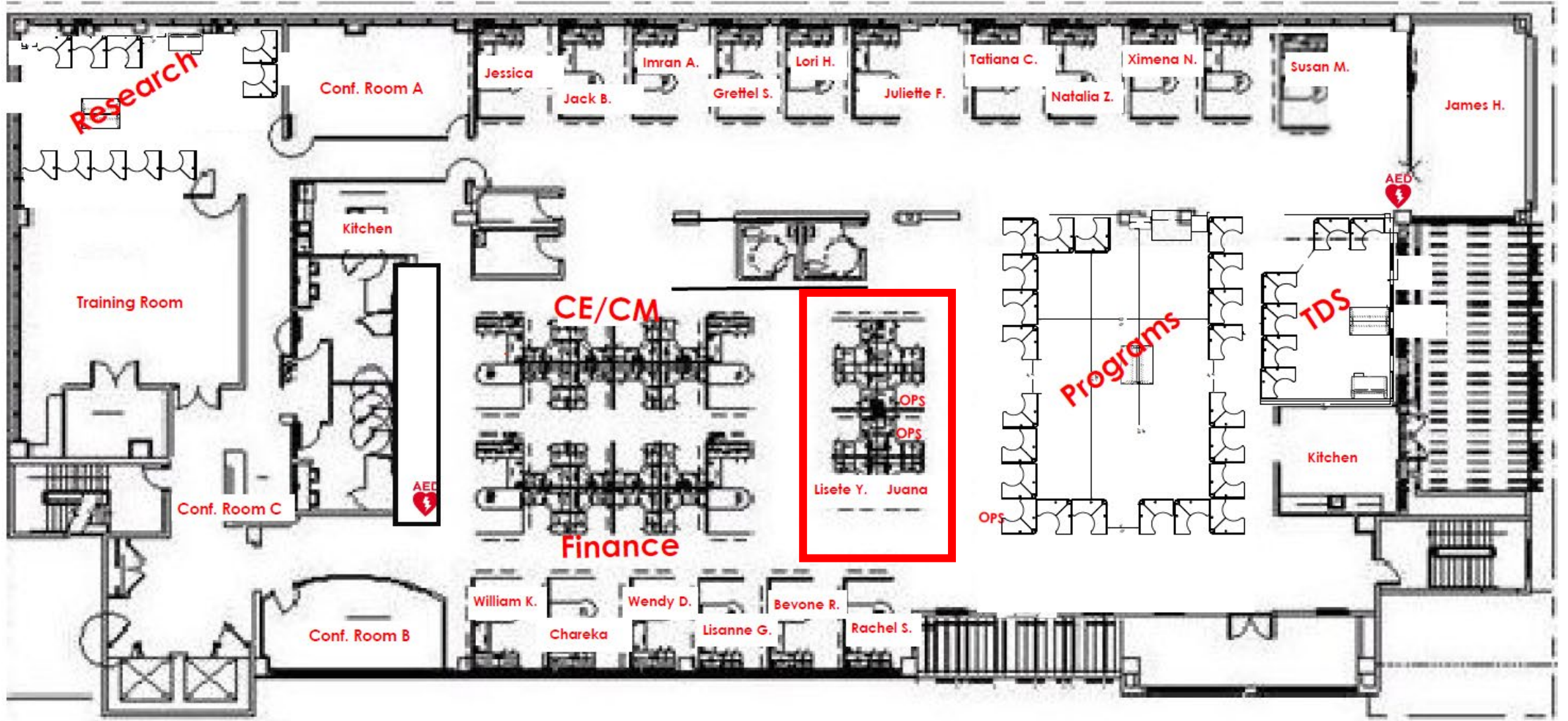

Research

Conf. Room A

Jessica

Jack B.

Imran A.

Grettel S.

Lori H.

Juliette F.

Tatiana C.

Natalia Z.

Ximena N.

Susan M.

James H.

Kitchen

Training Room

CE/CM

OPS

OPS

Lisete Y. Juana

Programs

TDS

Kitchen

Conf. Room C

AED

Finance

OPS

Conf. Room B

William K.

Chareka

Wendy D.

Lisanne G.

Bevone R.

Rachel S.

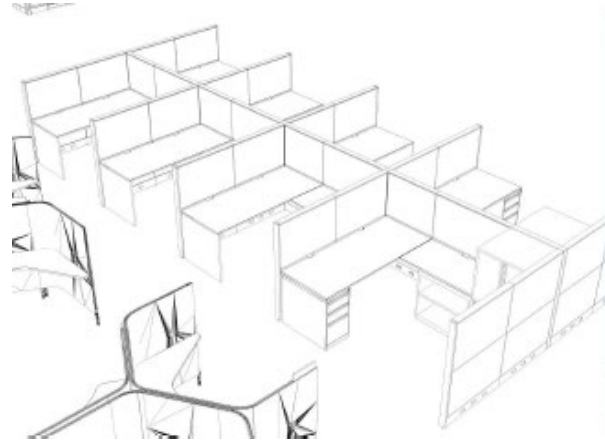
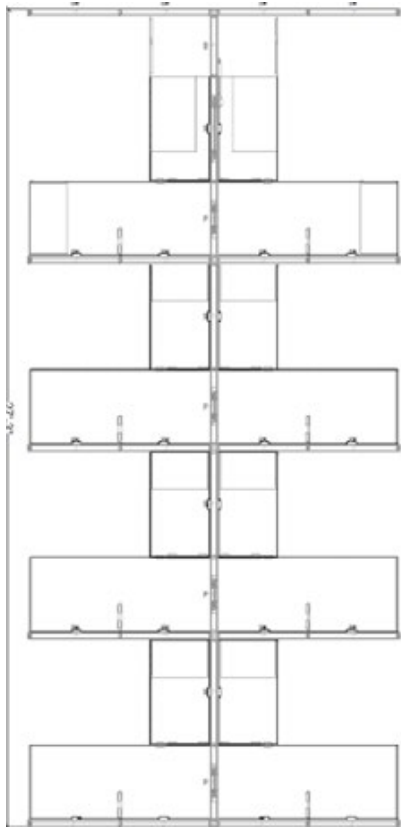

Additional Information:

- Need 8 spaces
- Same height as existing.
- Utilize frosted elements to allow light to pass through.
- Need storage solution.
- 2 desk facing windows need to have larger storage capacity.
- 1 desk closer to bathroom want to convert between storage area and office space at our discretion.
- Electricity will be provided by floor penetrations. Must identify number needed. Each penetration contains 4 outlets.

SAMPLE FURNITURE STYLE



OPS/Clerk of Board/Higher Privacy Need Area

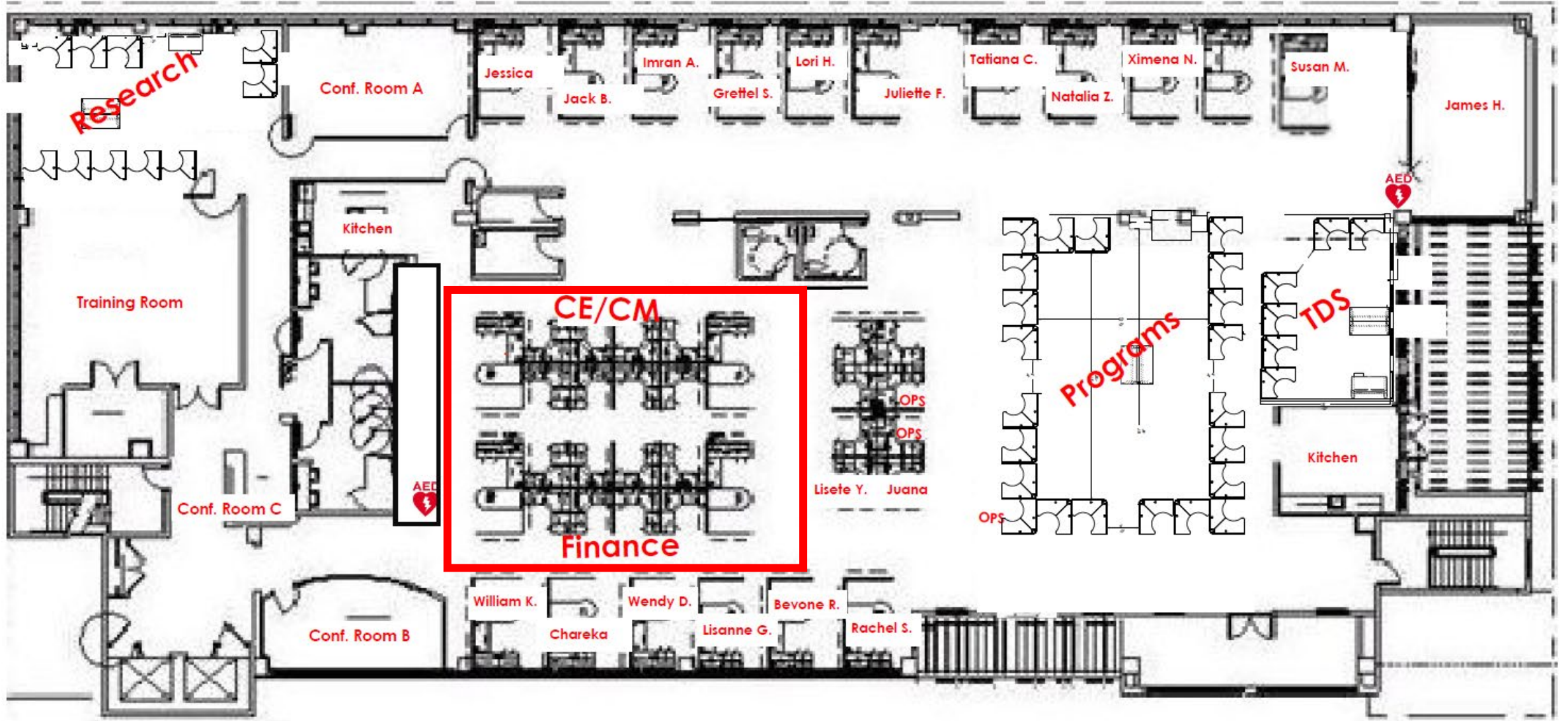

Research

Conf. Room A

Jessica

Imran A.

Lori H.

Tatiana C.

Ximena N.

Susan M.

James H.

CE/CM

Finance

Kitchen

Training Room

Conf. Room C

Conf. Room B

William K.

Wendy D.

Bevone R.

Rachel S.

Chareka

Lisanne G.

Programs

TDS

Kitchen

OPS

OPS

Lisete Y. Juana

OPS

AED

AED

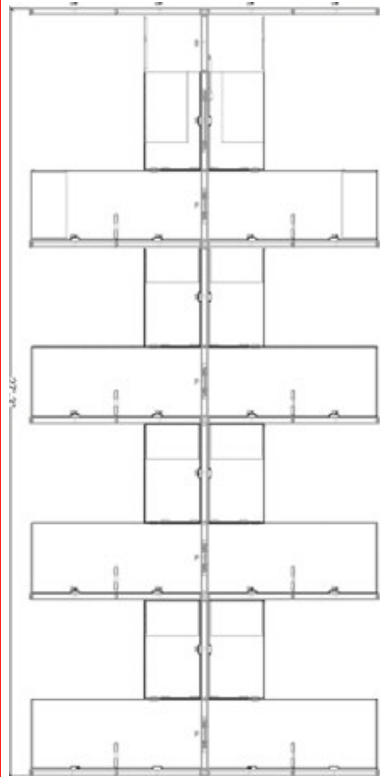
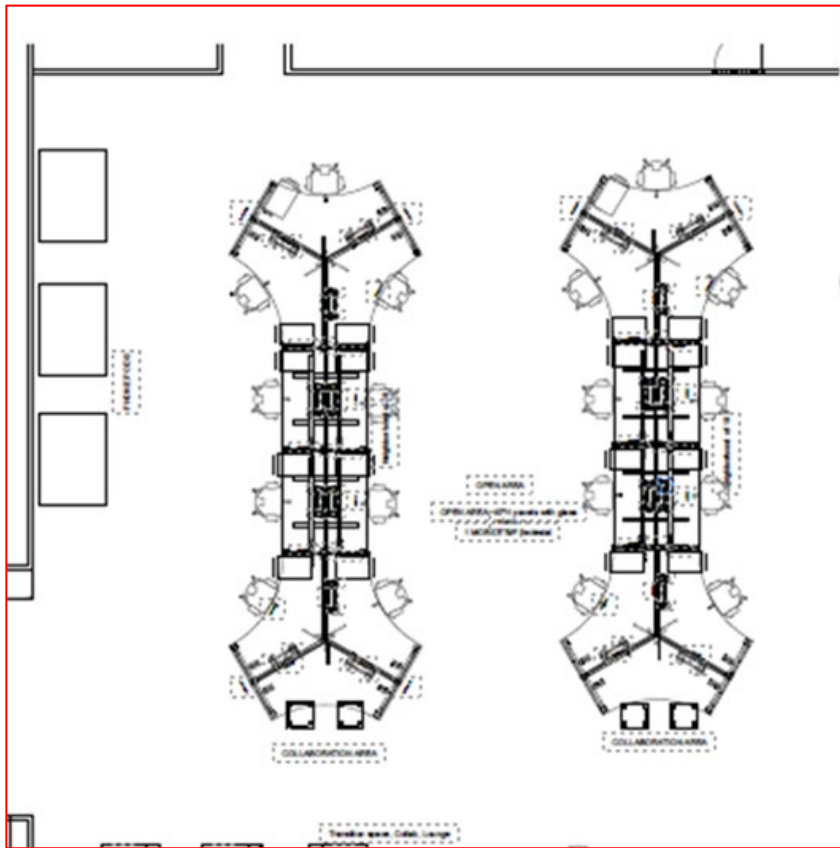

SAMPLE FURNITURE STYLE

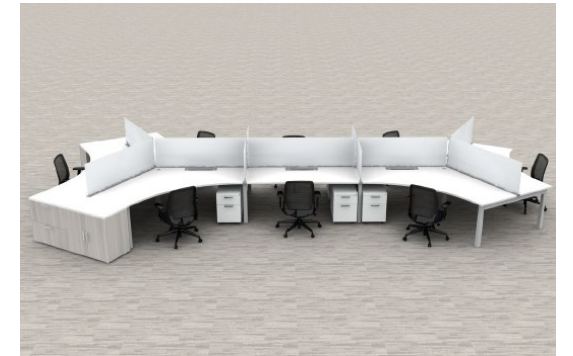

Additional
Information on
next page.

Finance/CE/Comms Area Option 1

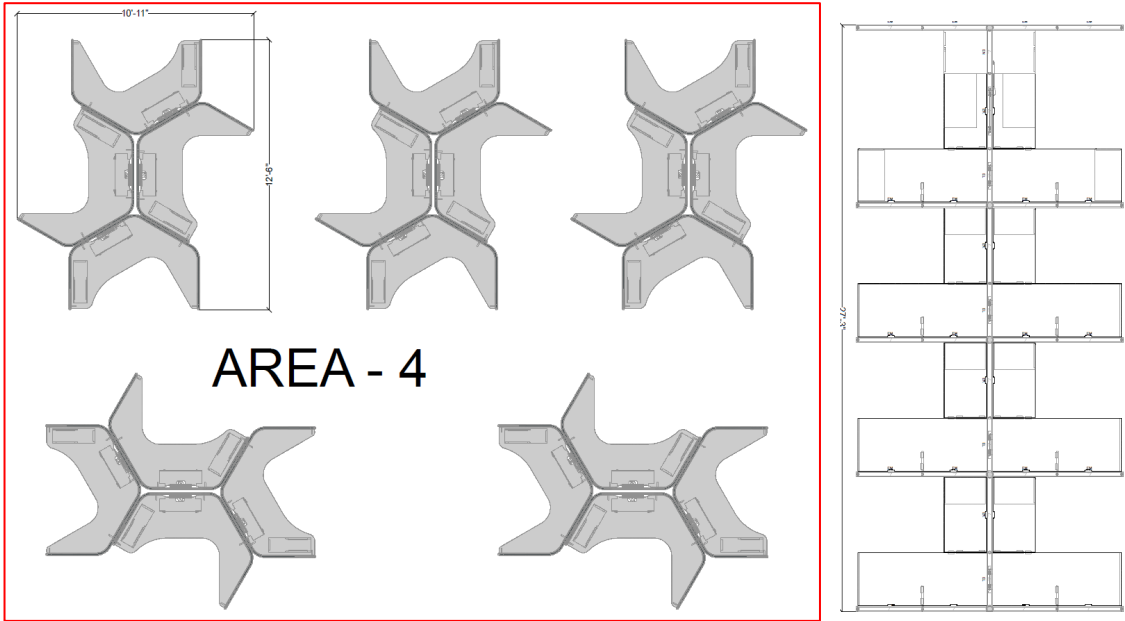

AREA - 4

SAMPLE FURNITURE STYLE



Additional Information:

- Need 20 spaces
- Same height as existing new programs area spaces.
- Incorporate frosted elements to allow light into back area but still maintain privacy.
- Provide small storage option similar to new programs area spaces.
- Configure for multiple waling paths through area that are not necessarily “straight lanes.”
- Electricity will be provided by floor penetrations. Must identify number needed. Each penetration contains 4 outlets.

Finance/CE/Comms Area Option 2